



## Patient Pouch Pattern

Skill Level-1 Button 

These little bags are easy to make and will provide comfort to a child during a difficult time.

Pattern is for sewers of all levels.



# Calling all Crafters!

Do you have extra material in your craft rooms and a little extra time to help a great cause? We need your help making drawstring bags for T&B Foundation to deliver “Patient Pouches” to Willis Eye Institute in Philadelphia.

Patient Pouches include lots of fun activities aimed at all different age ranges. Patient Pouches are intended to be at appointments that the children may have, whether receiving chemo, going into surgery, or just sitting in the waiting room. These little pouches will help pass the time away with fun activities to keep them busy.

Please send Patient Pouches to:

T&B Foundation  
c/o Lindsey Barnett  
12 Anna Avenue, Suite B  
Maple Shade, NJ 08052

To learn more about T&B Foundation by visiting our Facebook page  
[www.facebook.com/TandBFoundation](http://www.facebook.com/TandBFoundation) or emailing us at:

TandBFoundation (at) gmail (dot) com

# Pouch Construction

## Materials:

- 1/2 yard of medium weight fabric for body
- 1 1/2 yards of drawstring

\*Basic Sewing Supplies are needed to construct this pattern.

Just a note about fabric:

A medium weight cotton material is suggested for the base of the bag.

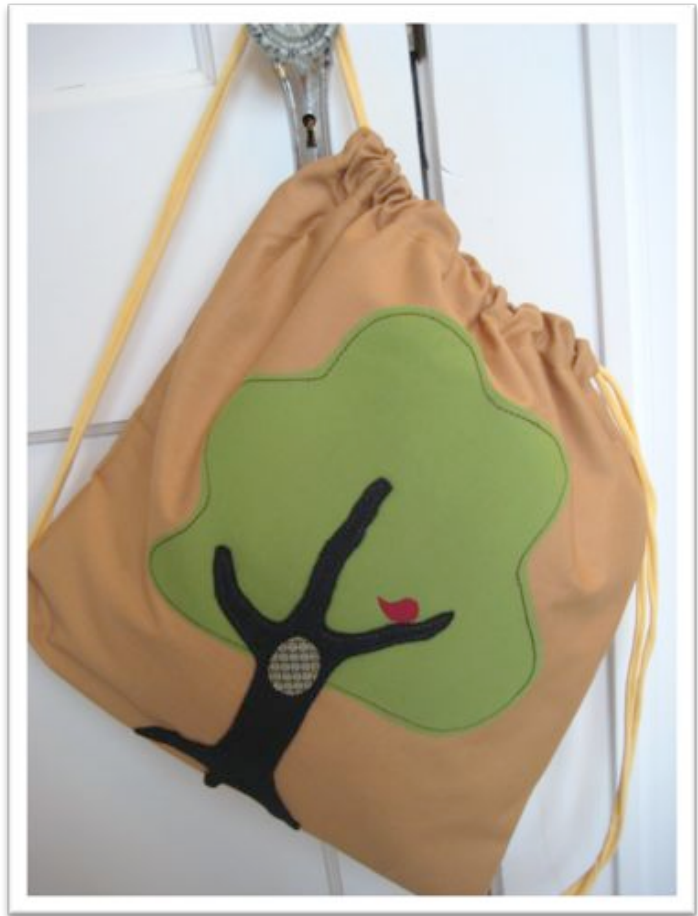

## Cutting Instructions:

1. Cut 2 pieces of medium weight woven fabric for body of pouch 15 3/4" tall x 10" wide.

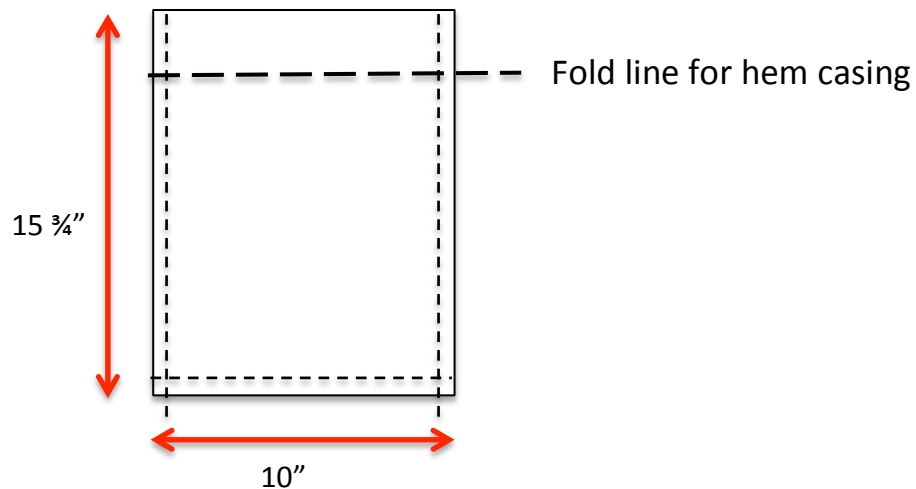

2. Cut 2 pieces of cording 25" long.

## Sewing Instructions:

1. Since this bag is not lined, I suggest clean finishing all sides of the front and back fabric pieces through an overlock/serger machine. This will take less than 5 minutes and is so worth it in the end. I always use a fun contrast color.
2. Pin right sides together (like a sandwich). In order for the drawstring to function, we need to create a pocket. So, with a disappearing ink pen, mark a small dot  $1\frac{3}{4}$ " from top edge and again at  $2\frac{3}{4}$ " from top edge. Repeat on opposite side.

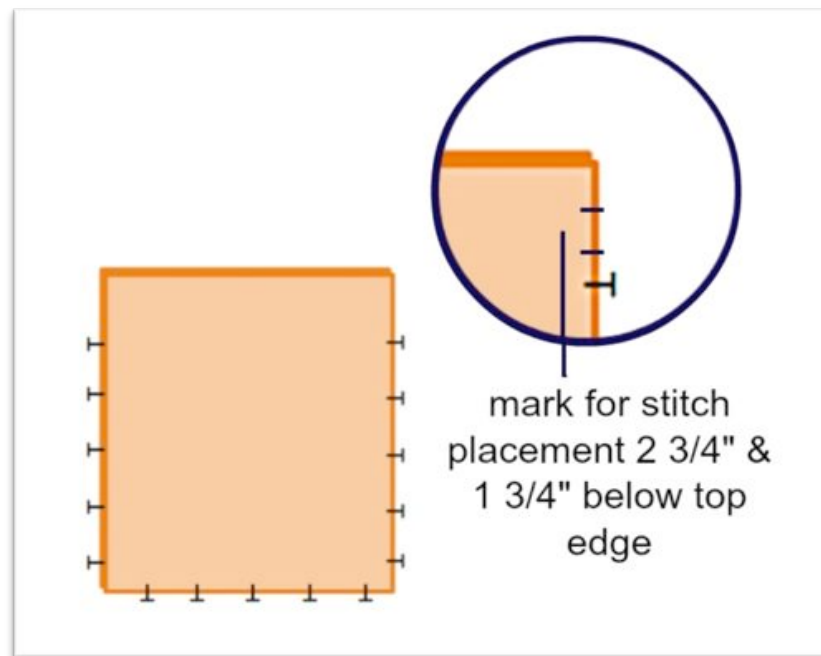

3. With the same color thread set your machine to straight stitch. Using  $\frac{1}{2}$ " seam allowance, stitch 3 sides together. You will start and stop at each dot. There should be **NO** stitching between the dots. Top edge will remain open.
4. Press seams open and clip bottom corners.
5. To keep the drawstring opening neat, use a straight stitch and stitch from top edge to the bottom of opening; with needle in down position, pivot and stitch along each side of seam. Repeat on other side.
6. To clean the top edge of bag, press under  $\frac{1}{4}$ " of top edge. Then fold and press  $1\frac{1}{4}$ " towards the wrong side of bag. Set your machine to a straight stitch and sew all around the top  $1\frac{1}{8}$ " from the edge.
7. Turn bag right side out and press.

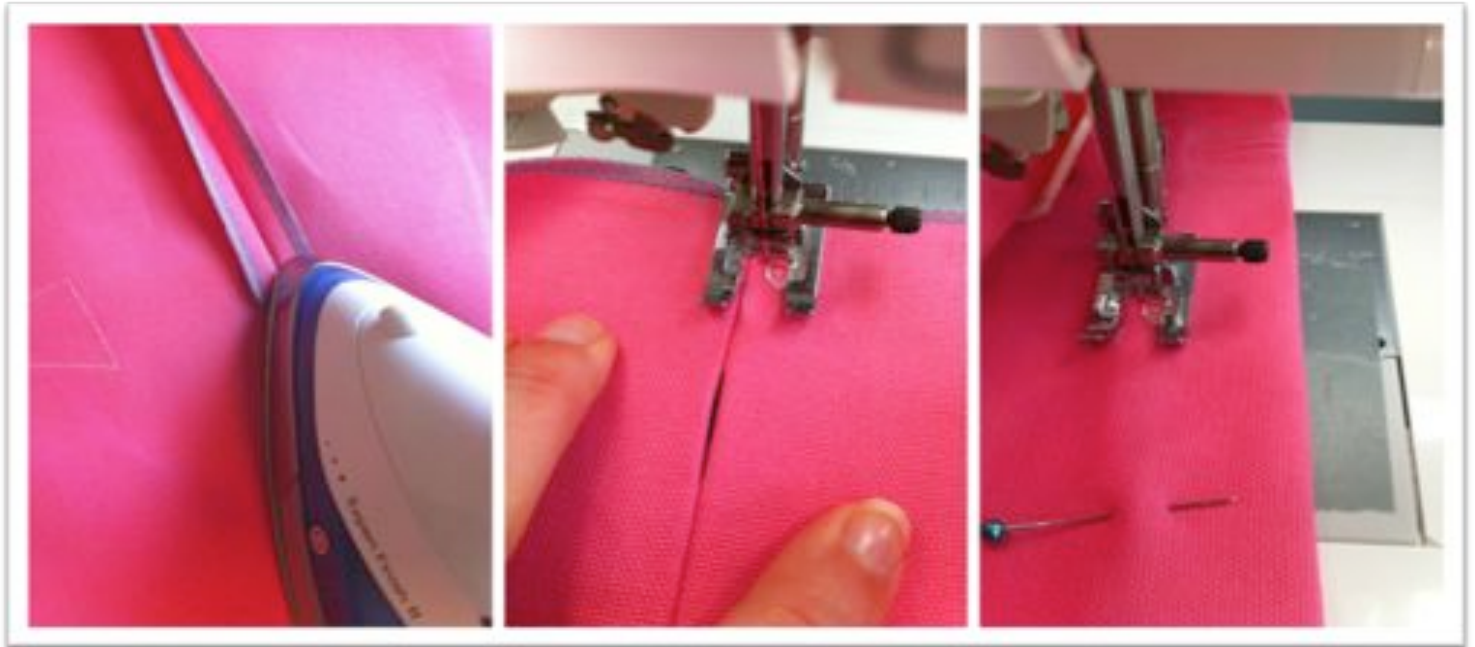

8. Next, take one piece of drawstring and attach it to a large safety pin to one end. Then slide the safety pin through the hole and all around the top of bag. It will come out the same hole where you started. Repeat with other piece on opposite side; knot drawstrings.

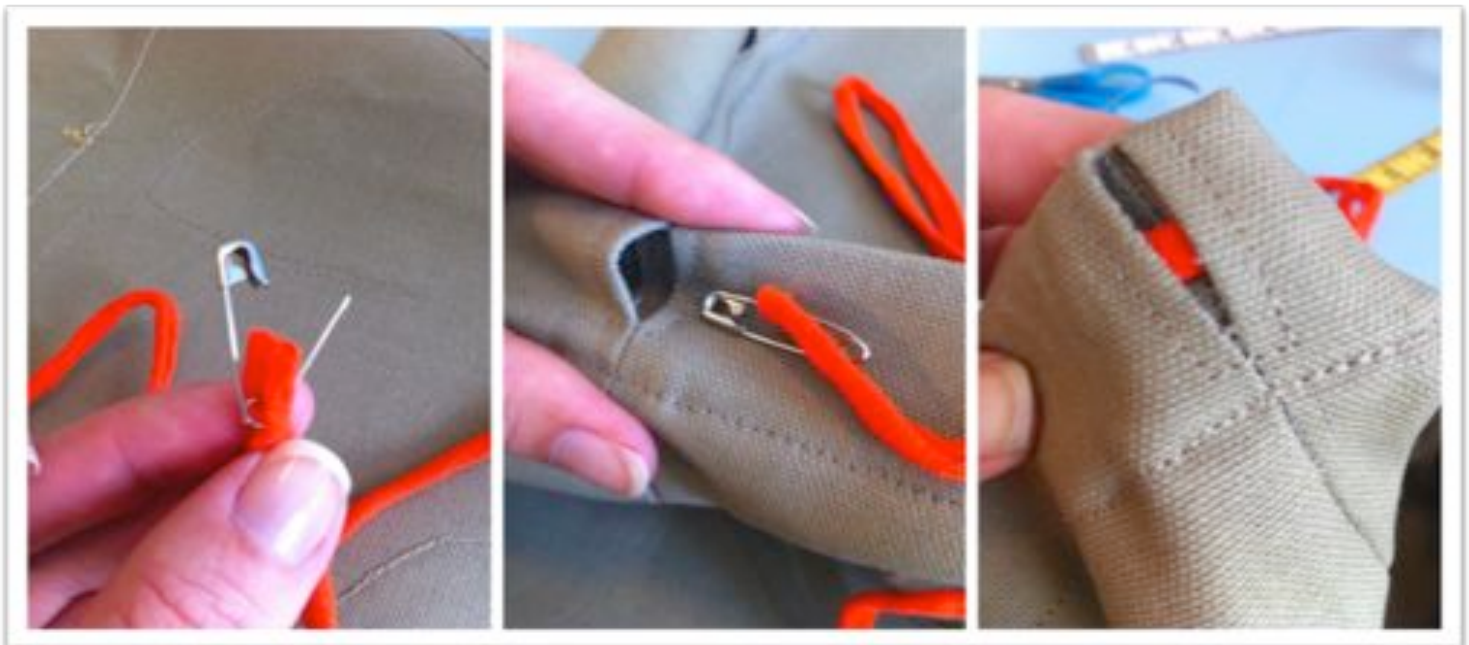



Please remember that this pattern was created for the T & B Foundation. Any reproduction of pattern instructions, photographs or designs is strictly prohibited. Items made from pattern cannot be sold. They are intended for the children of the foundation.

Please send Patient Pouches to:

T&B Foundation  
c/o Lindsey Barnett  
12 Anna Avenue, Suite B  
Maple Shade, NJ 08052

To learn more about T&B Foundation by visiting our Facebook page [www.facebook.com/TandBFoundation](http://www.facebook.com/TandBFoundation) or emailing us at:

TandBFoundation (at) gmail (dot) com



Heather Valentine of The Sewing Loft created pattern instructions for the T & B Foundation. For more easy sewing patterns and sewing tips visit [www.TheSewingLoft.com](http://www.TheSewingLoft.com)